

---

Q1325 - Costi haddad 1st, 03/703035, achrafieh

Rony Chiha  
4-8 Harley Crescent  
Condell Park  
NSW 2200  
P: +96170619421 M: +96171727274

**Quote Number: Q1325**  
Quote Valid for 30 days  
Building Type: Residential  
Quote Date: 14/01/2021

---

This apartment has been damaged by "Beirut Explosion" on the 4th of August 2020.  
Steps of Hope in collaboration with A-Tech Australia took the initiative to help in the renovation of damaged houses, to get people back to their homes before winter comes.

Apartment damages survey:

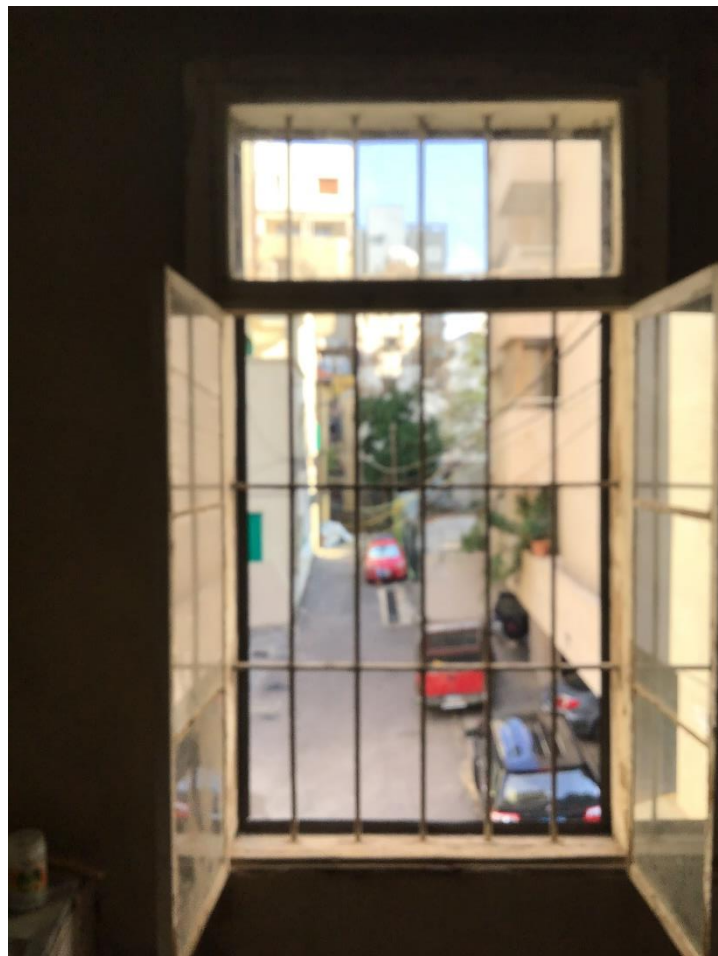

**Steps of Hope**

4-8 Harley Crescent Condell Park NSW 2200

Ph: 0474000444

[sohope.org.au](http://sohope.org.au)Email: [help@sohope.org.au](mailto:help@sohope.org.au)

ABN: 84636391298

Q1325 - Costi haddad 1st, 03/703035, achrafieh

**Estimate****Customer:**

Rony Chiha  
4-8 Harley Crescent  
Condell Park  
NSW 2200  
Ph: +96170619421  
Email: [help@sohope.org.au](mailto:help@sohope.org.au)

**Estimate Details:**

Net Total: \$1,300.00  
Markup: \$0.00 (0%)  
Tax: \$0.00  
**Estimate Total: \$1,300.00**

Building Type: Residential  
Date Prepared: 17/11/2020

**Cost Items**

Code	Description	Units / UOM	Unit Cost	Total
<b>1</b>	<b>Wood Work</b>			<b>\$1,300.00</b>
1.1	Window + glass + accessories	2.000	\$200.00	\$400.00
1.2	Kitchen Lamaica 5m	1.000	\$900.00	\$900.00

Net Total: \$1,300.00

Markup: \$0.00

Tax: \$0.00

**Estimate Total: \$1,300.00**





**Steps of Hope**

4-8 Harley Crescent Condell Park NSW 2200

Ph: 0474000444

[sohope.org.au](http://sohope.org.au)

Email: [help@sohope.org.au](mailto:help@sohope.org.au)

ABN: 84636391298